

















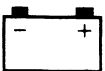



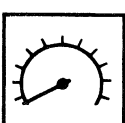
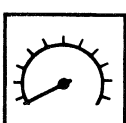

# FZS600(P)

5DM1-SE3

**2002 - 2003**

# SERVICE INFORMATION

①	GEN INFO				
②	SPEC				
③	CHK ADJ				
④	ENG				
⑤	COOL				
⑥	CARB				
⑦	CHAS				
⑧	ELEC				
⑨	TRBL SHTG		?		
⑩					
⑪					
⑫					
⑬					
⑭					
⑮		⑯		⑰	
⑱		⑲		⑳	
㉑		㉒		㉓	
㉔				㉕	New

EB003000

**SYMBOLS**

The following symbols are not relevant to every vehicle.

Symbols ① to ⑨ indicate the subject of each chapter.

- ① General information
- ② Specifications
- ③ Periodic checks and adjustments
- ④ Engine
- ⑤ Cooling system
- ⑥ Carburetor(-s)
- ⑦ Chassis
- ⑧ Electrical system
- ⑨ Troubleshooting

Symbols ⑩ to ⑰ indicate the following.

- ⑩ Serviceable with engine mounted
- ⑪ Filling fluid
- ⑫ Lubricant
- ⑬ Special tool
- ⑭ Tightening torque
- ⑮ Wear limit, clearance
- ⑯ Engine speed
- ⑰ Electrical data

Symbols ⑱ to ㉓ in the exploded diagrams indicate the types of lubricants and lubrication points.

- ⑱ Apply engine oil
- ⑲ Apply gear oil
- ⑳ Apply molybdenum disulfide oil
- ㉑ Apply wheel bearing grease
- ㉒ Apply lightweight lithium-soap base grease
- ㉓ Apply molybdenum disulfide grease

Symbols ㉔ to ㉕ in the exploded diagrams indicate the following:

- ㉔ Apply locking agent (LOCTITE®)
- ㉕ Use new one

**CONTENTS**

**SPECIFICATIONS**

**GENERAL SPECIFICATIONS** ..... 1

**MAINTENANCE SPECIFICATIONS** ..... 3

        ENGINE ..... 3

        CHASSIS ..... 4

        ELECTRICAL ..... 4

**LUBRICATION POINT AND LUBRICATION TYPES** ..... 5

        ENGINE ..... 5

**CABLE ROUTING** ..... 6

**PERIODIC CHECKS AND ADJUSTMENTS**

**INTRODUCTION** ..... 19

**PERIODIC MAINTENANCE/LUBRICATION INTERVALS** ..... 19

**FZS600 (P) 2002 WIRING DIAGRAM**



SPECIFICATIONS

GENERAL SPECIFICATIONS

Model	FZS600	
Model code:	5RT1 5RT2 5RT3	
Dimensions: Overall length  Overall height	2,080 mm (Except FIN, NOR) 2,175 mm (FIN, NOR) 1,180 mm	
Basic weight: With oil and full fuel tank	214 kg	
Oil type or grade: Engine oil	<div><div><div>Temp. °C</div><div><div>-20</div><div>-10</div><div>0</div><div>10</div><div>20</div><div>30</div><div>40</div></div><div><div>10W/30</div><div>10W/40</div><div>20W/40</div><div>20W/50</div></div></div><div>SAE20W40SE or SAE10W30SE</div></div> <td></td>	
Periodic oil change With oil filter replacement Total amount	2.5 L 2.7 L 3.5 L	
Fuel: Type Fuel tank capacity Fuel reserve amount	Regular unleaded gasoline 22 L 3.6 L	
Tire: Type Size front  rear  Manufacturer front rear Type front rear	Tubeless 110/70ZR 17 M/C (54W) 110/70ZR 17 (54W) 160/60ZR 17 M/C (69W) 160/60ZR 17 (69W) BRIDGESTONE/DUNLOP BRIDGESTONE/DUNLOP BT-57F/D207F BT-57R/D207J	
Tire pressure: Maximum load-except motorcycle Loading condition A* front rear Loading condition B* front rear High-speed riding front rear	183 kg 0 ~ 90 kg 225 kPa (2.25 kg/cm <sup>2</sup> , 2.25 bar) 250 kPa (2.5 kg/cm <sup>2</sup> , 2.5 bar) 90 ~ 183 kg 225 kPa (2.25 kg/cm <sup>2</sup> , 2.25 bar) 290 kPa (2.9 kg/cm <sup>2</sup> , 2.9 bar)  225 kPa (2.25 kg/cm <sup>2</sup> , 2.25 bar) 290 kPa (2.9 kg/cm <sup>2</sup> , 2.9 bar)	

\* Load is the total weight of cargo, rider, passenger, and accessories.

GENERAL SPECIFICATIONS

SPEC



Model	FZS600
Bulb voltage, wattage × quantity:	
Headlight	12 V 60 W/55 W × 2
Auxiliary light	12 V 5 W × 2
Tail/brake light	12 V 5 W/21 W × 2
Front turn signal light	12 V 21 W × 2
Rear turn signal light	12 V 21 W × 2
Meter light	14 V 14 W × 3
Indicator light	
Neutral indicator light	12 V 1.4 W × 1
High beam indicator light	12 V 1.4 W × 1
Oil level warning light	12 V 1.4 W × 1
Turn signal indicator light	12 V 1.4 W × 2
Fuel level warning light	12 V 2 W × 1
Engine temperature warning light	LED



MAINTENANCE SPECIFICATIONS  
ENGINE

Item		Standard	Limit
Carburetor:			
I.D. mark		5DM1 01	...
Main jet	(M.J)	#115	...
Main air jet	(M.A.J)	#80	...
Jet needle	(J.N)	5D86-3/5	...
Needle jet	(N.J)	P-0M	...
Pilot air jet	(P.A.J.1)	#130	...
Pilot outlet	(P.O)	0.95	...
Pilot jet	(P.J)	#12.5	...
Bypass 1	(B.P.1)	0.9	...
Bypass 2	(B.P.2)	0.8	...
Bypass 3	(B.P.3)	0.8	...
Pilot screw	(P.S)	2-1/2	...
Valve seat size	(V.S)	1.0	...
Starter jet	(G.S.1)	0.6	...
Starter jet	(G.S.2)	0.8	...
Throttle valve size	(TH.V)	#110	...
Fuel level	(F.L) (with special tool)	3.5 mm	...
Engine idle speed		1,150 ~ 1,250 r/min	...
Intake vacuum		31.7 ~ 34.3 kPa (238 ~ 257 mmHg)	...

TIGHTENING TORQUES  
ENGINE

Part to be tightened	Part name	Thread size	Q'ty	Tightening torque		Remarks
				Nm	m•kg	
Radietor cover	Bolt	M5	2	7	0.7	

CHASSIS

Item	Standard	Limit
Drive chain:		
Type/manufacturer	50VA4/DAIDO	...
No. of links	110	...
Chain free play	30 ~ 45 mm	...
Maximum ten-link section	150 mm	...

TIGHTENING TORQUES

CHASSIS

Part to be tightened	Part name	Thread size	Q'ty	Tightening torque		Remarks
				Nm	m•kg	
Front cowling stay	Nut	M8	2	33	3.3	

ELECTRICAL

Item	Standard	Limit
Charging system:		
Type	A.C. magneto	...
Model/manufacturer	F4T377/MITSUBISHI	...
Standard output	14 V 21 A at 5,000 r/min	...
Stator coil resistance	0.28 ~ 0.34 Ω at 20°C/W-W	...
Rectifier:		
Model/manufacture	SH650C-11/SHINDENGEN	...
Capacity	18 A	...
Withstand voltage	200 V	...
Fuel gauge:		
Model/manufacture	5RT/NIPPON SEIKI	...
Sender unit resistance-full	4 ~ 10 Ω	...
-empty	122.5 ~ 128.5 Ω	...
Amperage for individual circuit:		
Main	30 A	...
Headlight	20 A	...
Signal	10 A	...
Ignition	20 A	...
Fan	10 A	...
Back up	10 A	...
Reserve	30 A	...
	20 A	...
	10 A	...
Thermo unit:		
Model/manufacture	5JJ/NIPPON THERMOSTAT	...
Resistance	3413 ~ 4007 Ω at 80°C	...
	1645 ~ 1855 Ω at 105°C	...

LUBRICATION POINT AND LUBRICATION TYPES

SPEC



LUBRICATION POINT AND LUBRICATION TYPES  
ENGINE

Lubrication Point	Symbol
Cylinder head tightening nut washer	





EB205000

## CABLE ROUTING

- ① Throttle cables
- ② Clutch cable
- ③ Left handlebar switch lead
- ④ Starter cable
- ⑤ Main switch
- ⑥ Main switch lead
- ⑦ Brake hose
- ⑧ Speed sensor lead
- ⑨ Right handlebar switch lead

- A** Using clamp, left handlebar switch lead to crimped part of clutch cable fitting. After clamping, cut excessive portion from tip.
- B** Using clamp, bundle:
  - Left handlebar switch lead
  - Clutch cable
  - Starter cable
- C** 30 mm or less from the top of protector.
- D** Pass speed sensor lead through clamp code 1.
- E** Fix speed sensor lead with clamp so that brake hose is on the outside of frame. Clamp the speed sensor lead after clamping at 3 lower positions so that it can not become slack.
- F** 10 mm or less from the bottom of protector.

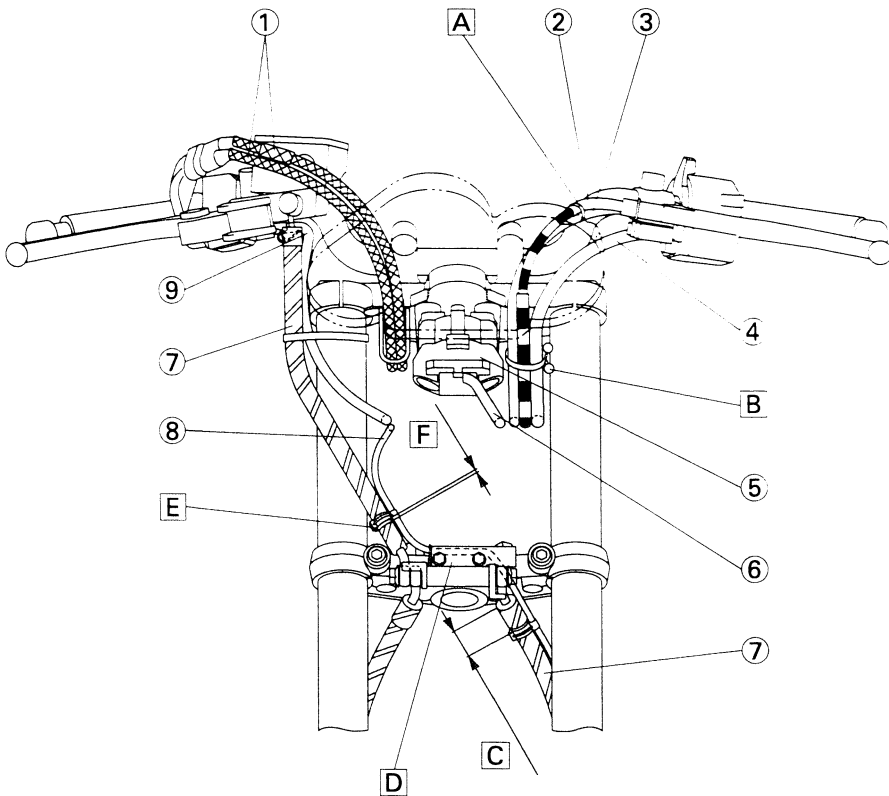



- |                                  |                              |   |
|----------------------------------|------------------------------|---|
| ① Main switch lead               | ⑭ Starter relay              | ⑳ Rectifier/regulator lead              |
| ② Starter cable                  | ⑮ Battery positive lead      | ㉑ Horn                                  |
| ③ Left handlebar switch lead     | ⑯ Seat lock cable            | ㉒ Brake hose                            |
| ④ Clutch cable                   | ⑰ Seat lock stay             | ㉓ Speed sensor lead                     |
| ⑤ Horn lead                      | ⑱ Cross tube 3               | ㉔ Fuse box                              |
| ⑥ Rectifier/regulator            | ㉒ A.C. magneto lead          | ㉕ Rear fender                           |
| ⑦ Box                            | ㉓ Starter motor lead         | ㉖ Wire harness                          |
| ⑧ Air guide                      | ㉔ Cross tube                 | ㉗ Pickup coil lead coupler              |
| ⑨ Radiator fan motor lead        | ㉕ Air filter case drain hose | ㉘ Sidestand switch lead coupler         |
| ⑩ Spark plug lead 1              | ㉖ Sidestand switch lead      | ㉙ Oil level/neutral switch lead coupler |
| ⑪ Starting circuit cut-off relay | ㉗ Neutral switch             | ㉚ A.C. magneto lead coupler             |
| ⑫ Battery                        | ㉘ Oil level switch lead      | ㉛ Oil level/neutral switch lead         |
| ⑬ Turn signal relay              | ㉙ Radiator                   |   |

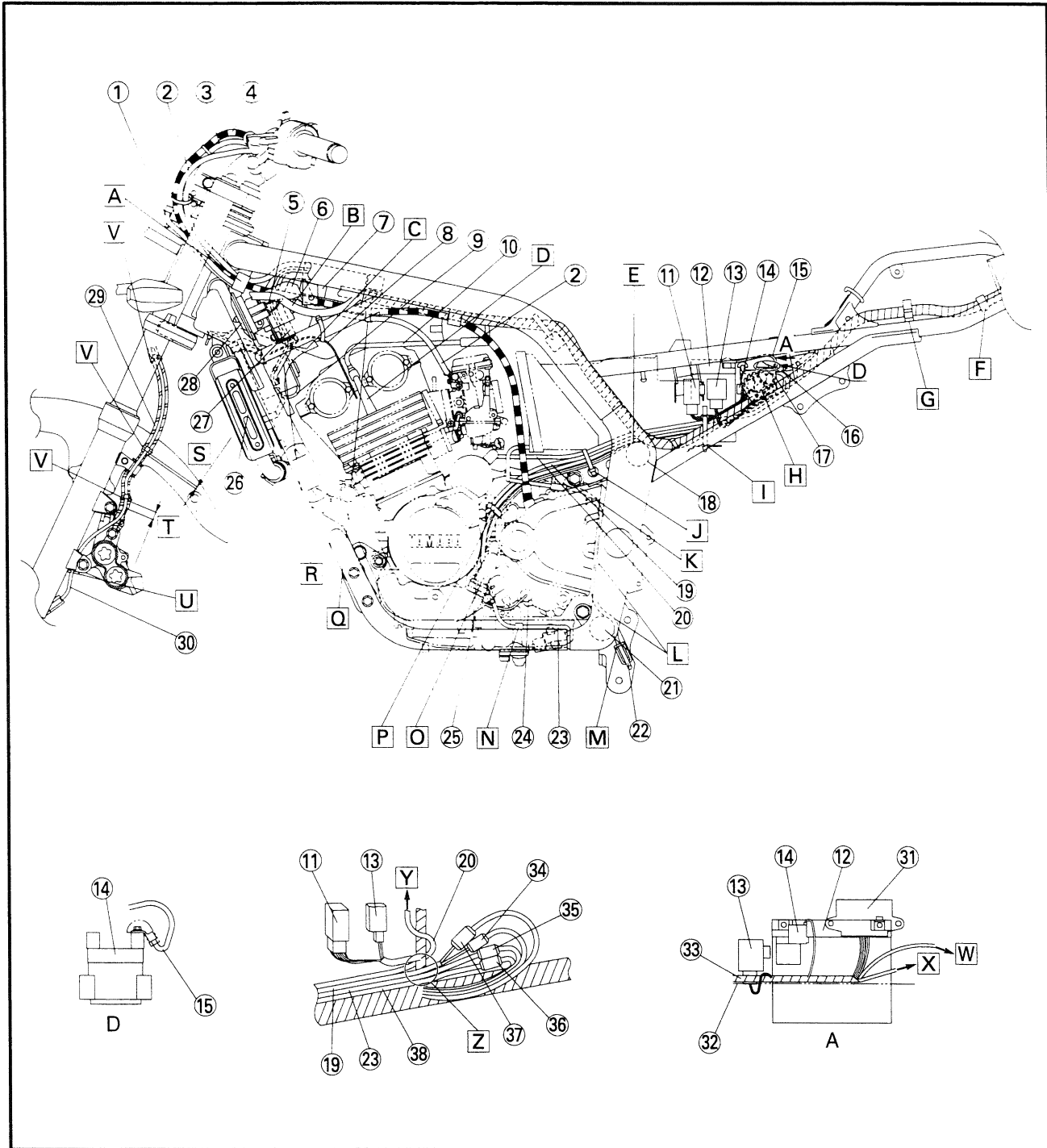

**A** Using clamp, fix:

- Left handlebar switch lead
- Main switch lead
- Clutch cable
- Starter cable

In so doing, locate main switch lead innermost.

**B** To headlight sub-wire harness**C** Radiator fan motor lead, pass this lead through hole in air guide and then into box.**D** Install plug cap so that spark plug lead face toward inside of vehicle.**E** Wire harness, starter motor lead, A.C. magneto lead, side-stand switch lead and neutral switch lead pass the over cross tube 3.**F** Using clamp, fix wire harness to the frame.**G** Using clamp, fix wire harness to the frame.**H** After connecting coupler, push then on the inside of lock stay on the frame.**I** Using clamp, fix to bracket on the frame:

- Wire harness (at white taping)
- Starter motor lead
- A.C. magneto lead
- Sidestand switch lead
- Oil level switch lead
- Neutral switch lead

Locate wire harness outermost. Locate clamp with its tip outward of frame so that it does not protrude through clearance between side cover and frame.

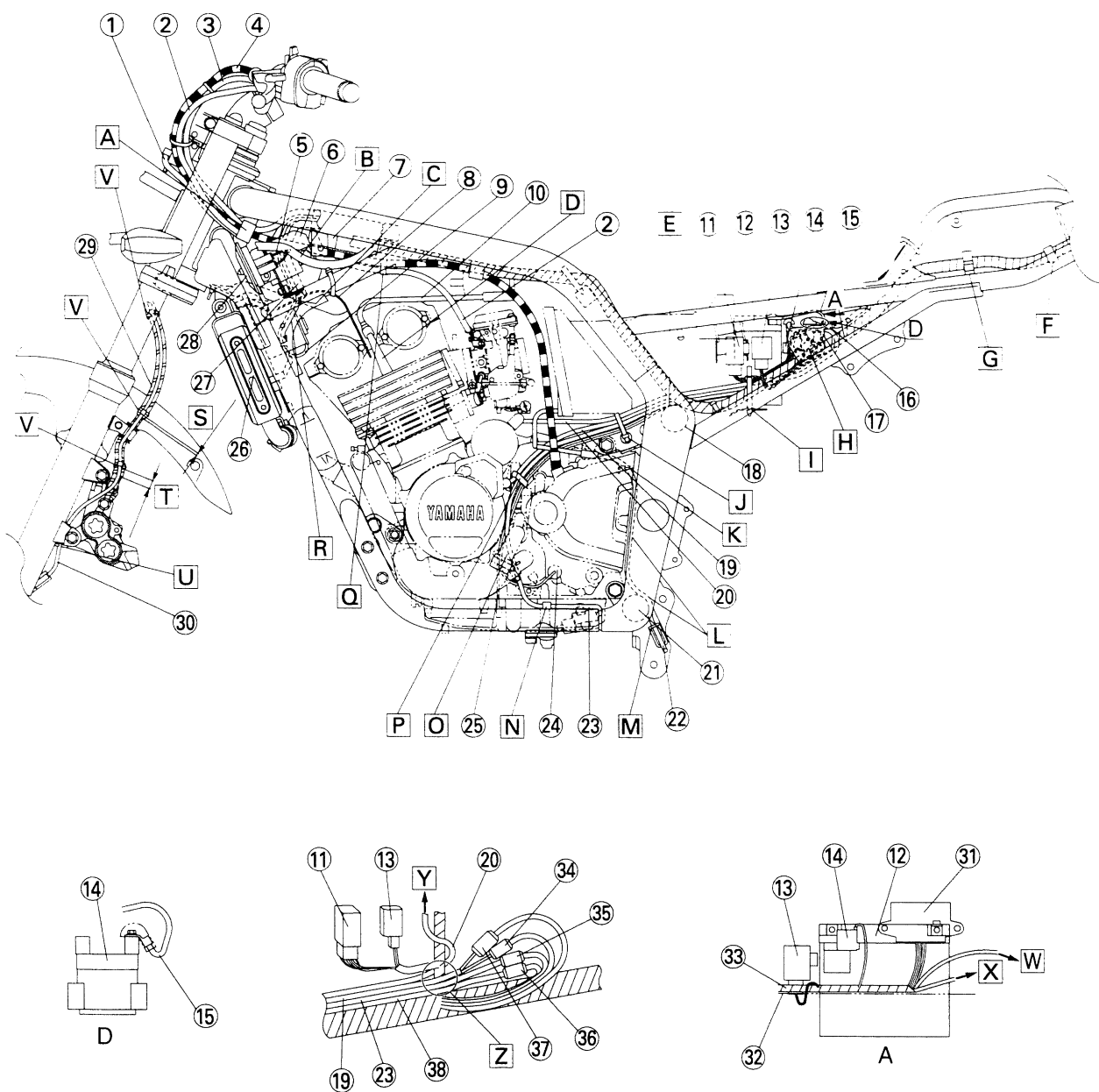



- J** Using clamp, fix to bracket on frame:
- Stator motor lead
  - Sidestand switch lead
  - Oil level switch lead
  - Neutral switch lead
- Locate wire harness outermost. Locate clamp with its tip downward and cut off excessive length.
- K** Pass air filter drain hose through clamp on engine.
- L** Air filter case drain hose in front of swingarm pivot shaft and in rear of cross tube.
- M** Pass air filter case drain hose through the rear suspension bracket holder and out on left side of vehicle.
- N** Using clamp, fix sidestand switch lead to frame.
- O** Pass sidestand switch lead behind water pipe.
- P** Using clamp on engine, fix:
- A.C. magneto lead
  - Sidestand switch lead
  - Oil level switch lead
  - Neutral switch lead
- Q** Pass on the outside of spark plug lead 1
- Clutch cable
  - Starter cable
- R** Radiator fan motor lead shall permit no slack in this range.
- S** 10 mm or less from the bottom of protector.
- T** 10 mm or less from the bottom of protector.

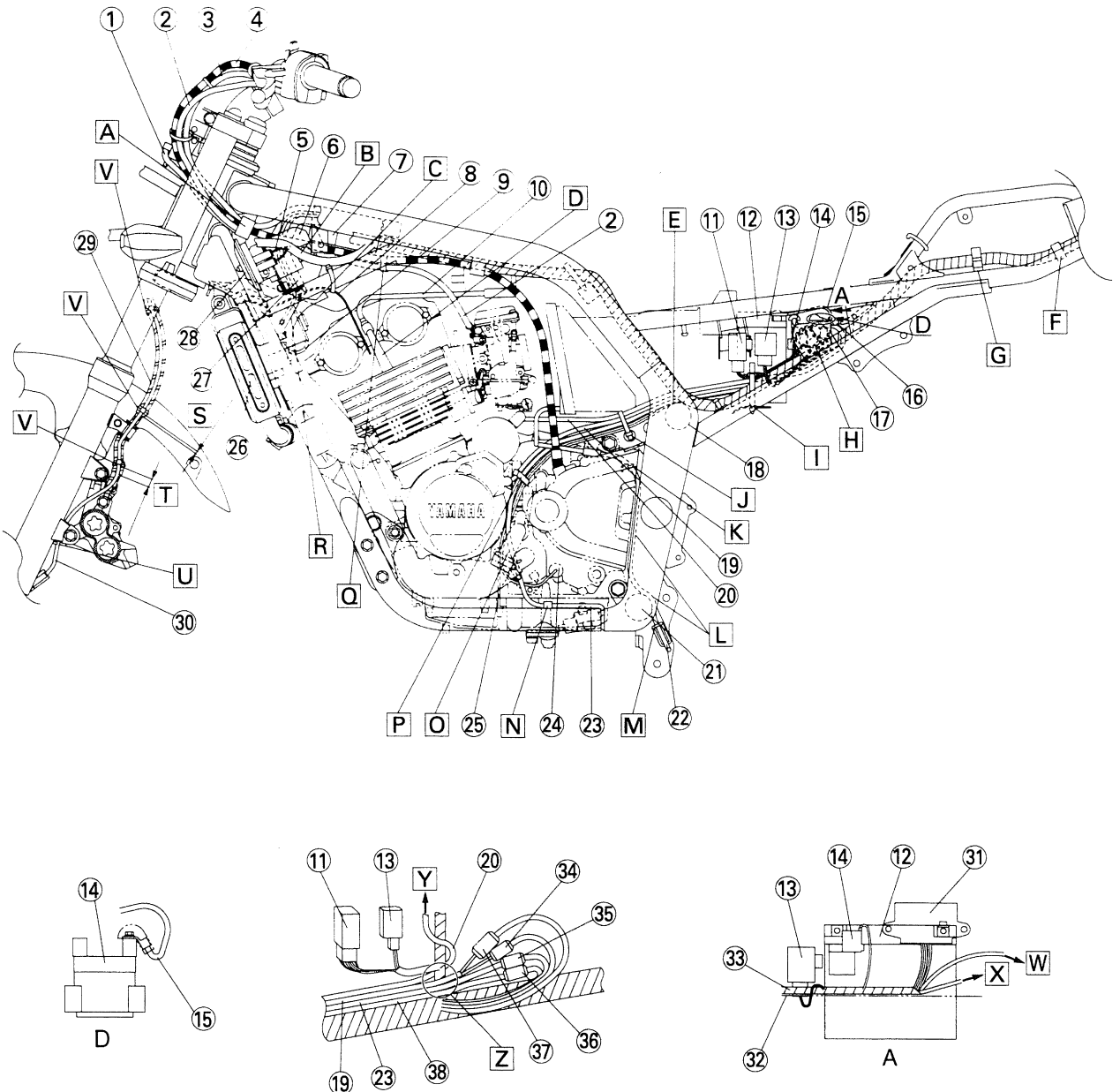



- U** Using holder, fix speed sensor lead to outer tube.
- V** Pass speed sensor lead along brake hose on the outside of frame and fix it with clamp (at 3 positions).
- W** To stop switch
- X** To battery negative lead
- Y** To starter relay
- Z** Pass only starter motor lead behind wire harness branch.

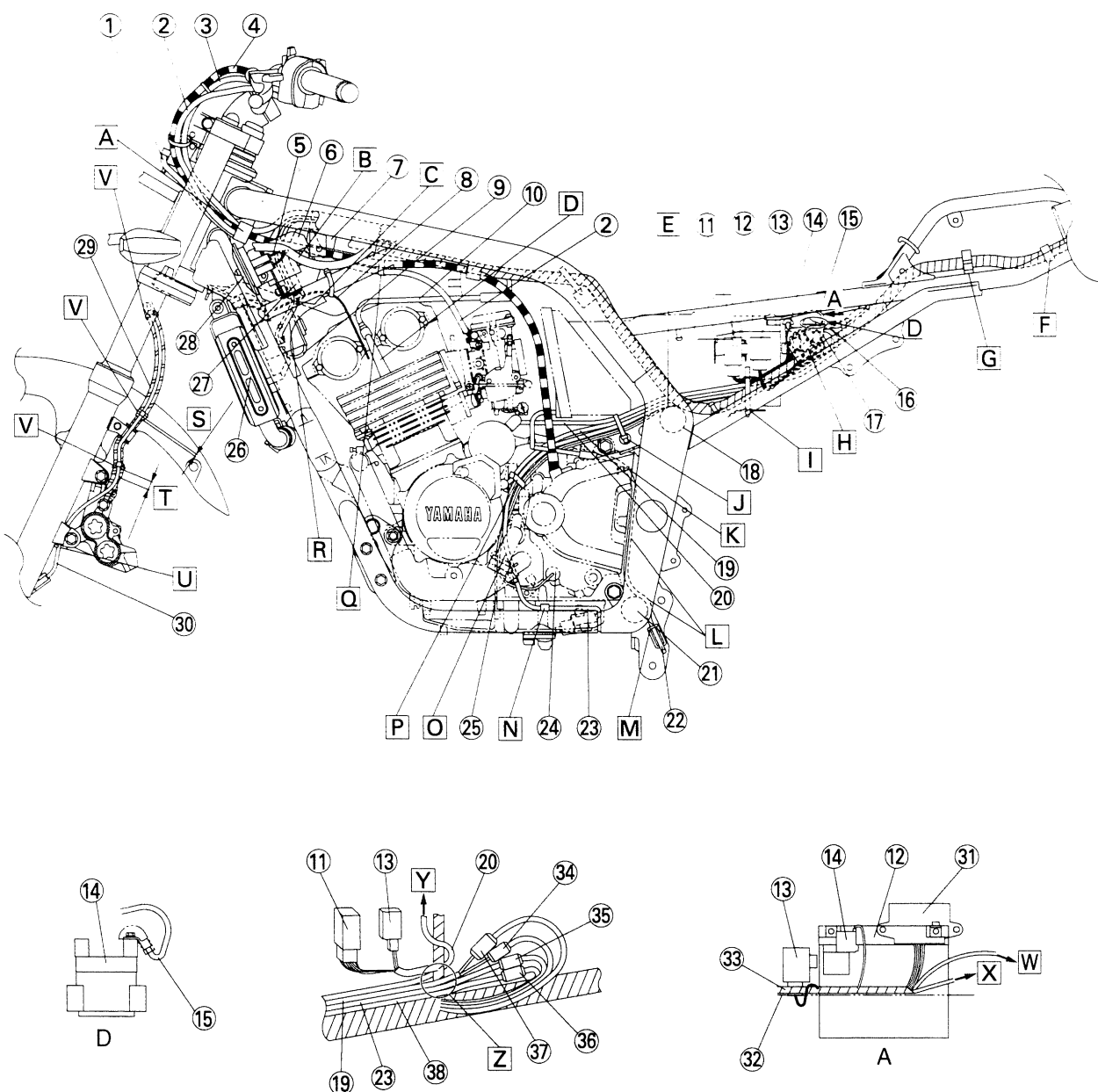



- |   |   |
|---|---|
| ① Right handlebar switch lead           | ⑩ Battery negative lead                 |
| ② Throttle cables                       | ⑪ Cross tube 3                          |
| ③ Brake hose                            | ⑫ Radiator reservoir tank breather hose |
| ④ Cable guide                           | ⑬ Air filter                            |
| ⑤ Main switch lead                      | ⑭ Throttle position sensor lead         |
| ⑥ Radiator reservoir tank               | ⑮ Box                                   |
| ⑦ Rear brake light switch lead          | ⑯ Speed sensor lead                     |
| ⑧ Battery                               | ⑰ Engine bracket 3                      |
| ⑨ Radiator reservoir tank breather hose | ⑱ Swingarm bracket                      |

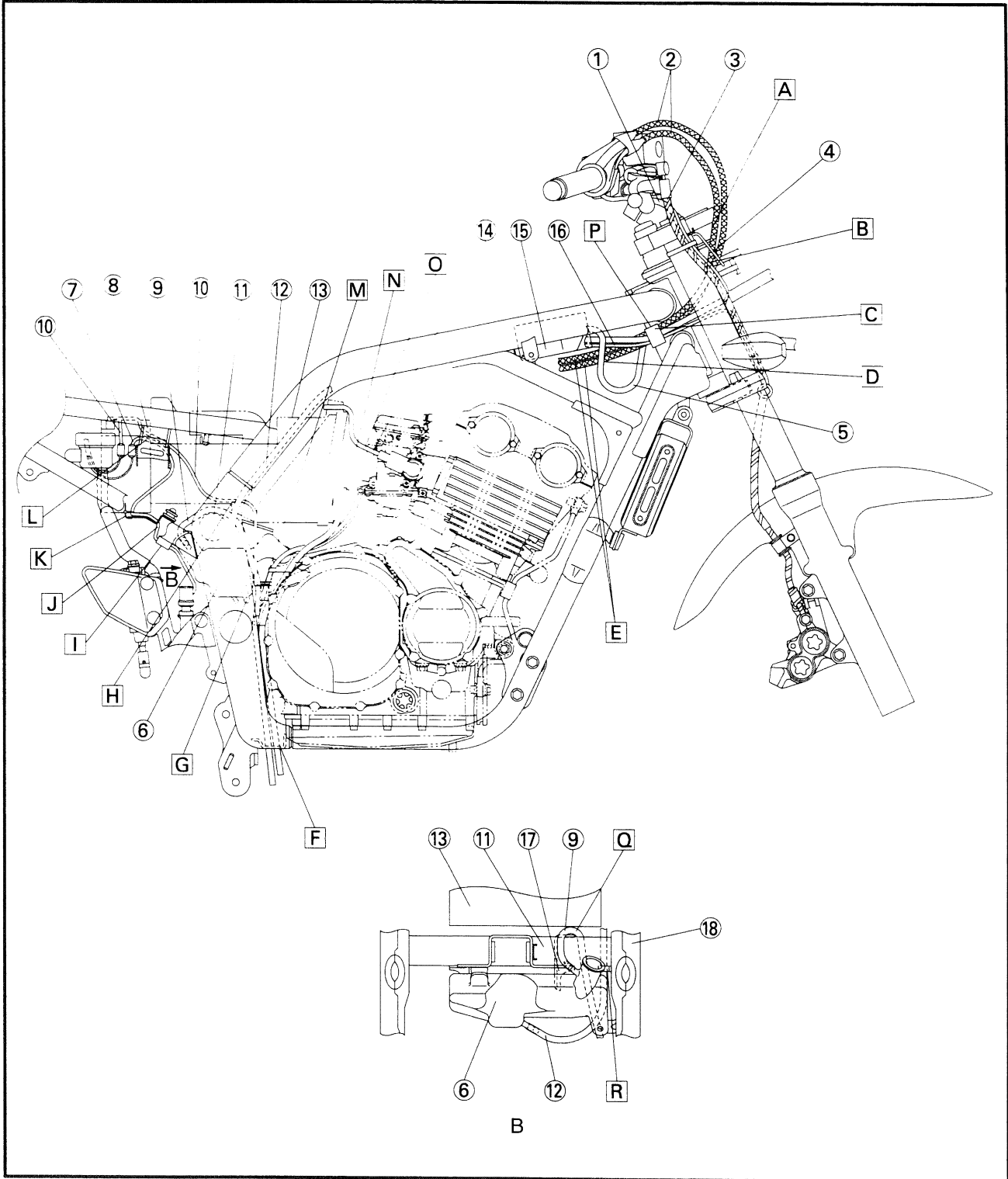



- A** Using clamp, fix to the front fork:
- Right handlebar switch lead
  - Brake hose
- Locate clamp with its head inward of frame.
- B** Pass throttle cables through guide.  
Throttle cable installed to upper bracket.
- C** With its pulling side on top. Pass throttle cable innermost of clamp.
- D** Pass main switch lead under:
- Throttle cable (2 pcs)
  - Right handlebar switch lead
  - Speed sensor lead
- And them into box at right side. In so doing, give leads some slack.
- E** Pass throttle cable under box.
- F** Pass through holder on frame:
- Radiator reservoir tank breather hose
  - Fuel tank breather hose
- G** To reservoir tank
- H** Pass battery negative lead on the inside of radiator reservoir tank breather hose.
- I** Using clamp, fix stop switch lead to frame. Locate clamp with its latch outward of frame.
- J** Pass on the inside of side cover insertion position.

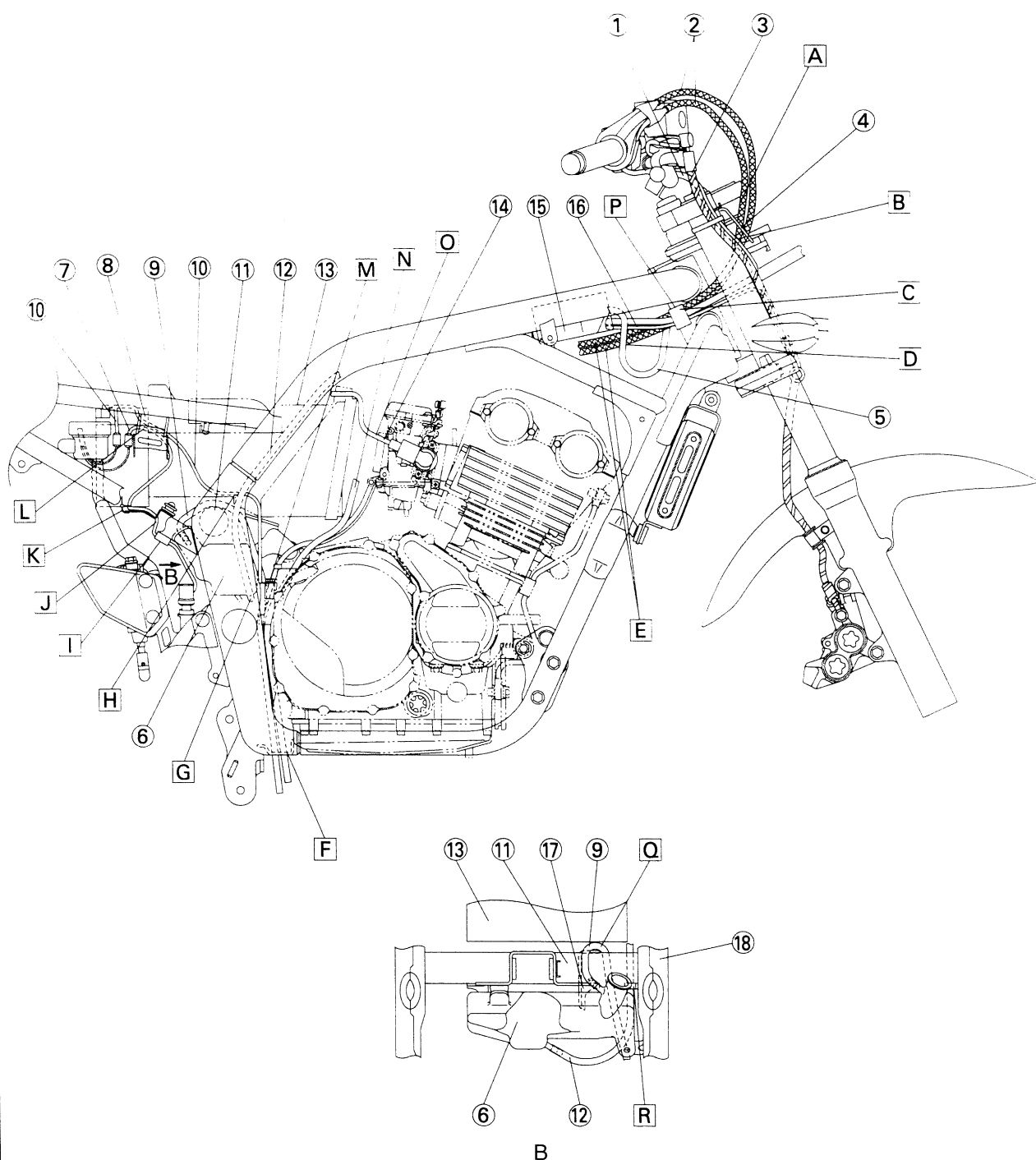



- K** Pass through hole in bracket battery and clamp rear brake light switch lead.
- L** Pass on the inside of air filter bracket, on frame:
  - Battery negative lead
  - Brake light switch lead
- M** Pass between swingarm head pipe and engine crankcase:

- Fuel tank drain hose
- Fuel tank breather hose
- Radiator reservoir tank breathe hose

- N** Fuel tank drain hose install so that it is not bent or slack.
- O** After passing throttle position sensor lead as shown, install cover 2 to air filter.

- P** Fix throttle cables, right handlebar switch lead and speed sensor lead to the frame with a clamp.
- Q** Pass radiator reservoir tank breathe hose between air filter and cross tube 3, and on the outside of the engine bracket 3.
- R** Fix radiator reservoir tank breathe hose to swingarm bracket on frame with a clamp.

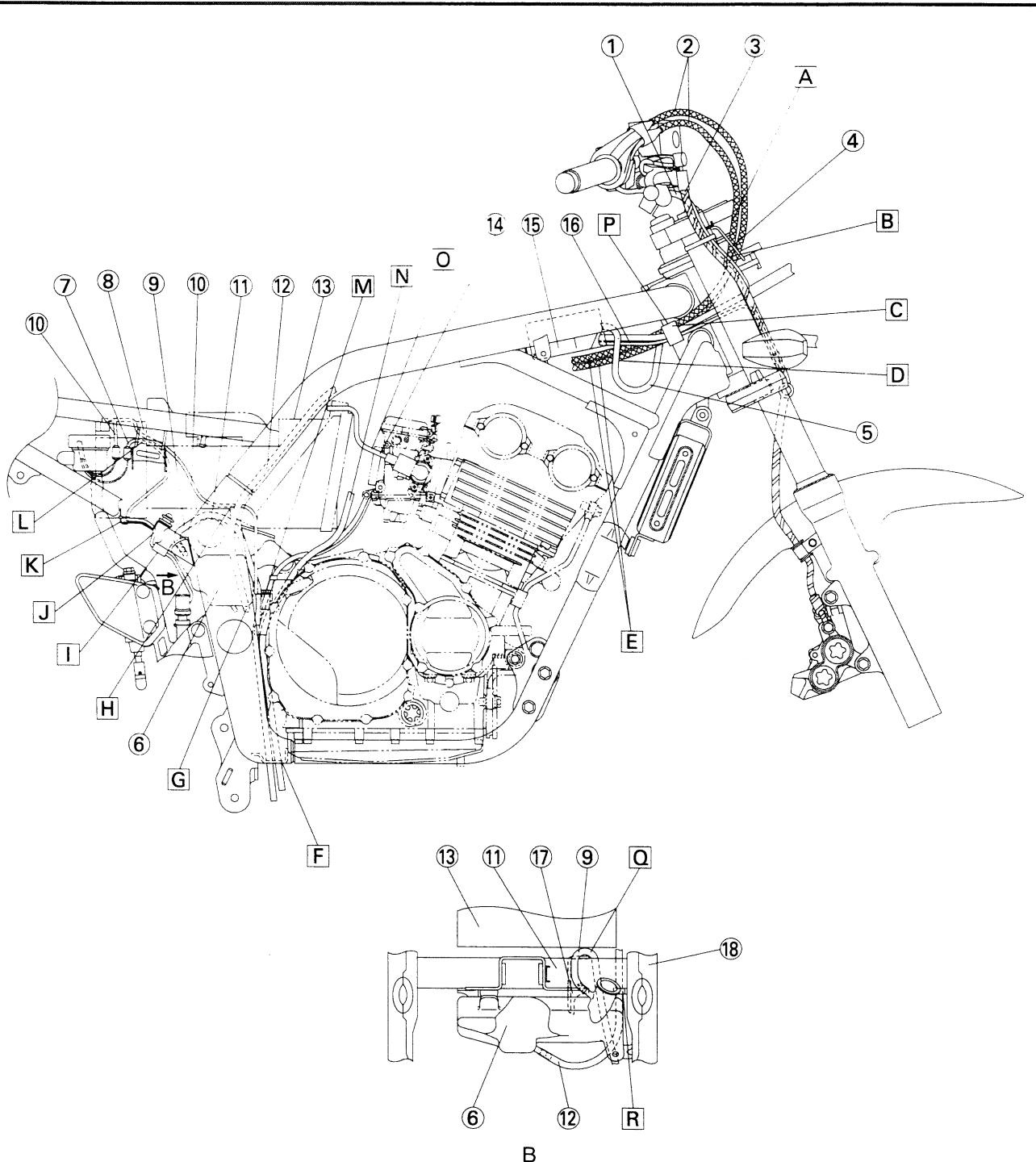





- |   |                                  |                                       |
|---|----------------------------------|---------------------------------------|
| ① Throttle cables                       | ⑨ Fuel tank breather hose        | ⑲ Rear brake reservoir tank           |
| ② Speed sensor lead                     | ⑩ Fuel tank drain hose           | ⑳ Rear brake right switch lead        |
| ③ Right handlebar switch lead           | ⑪ Pipe 2                         | ㉑ Fuse box                            |
| ④ Thermostat housing                    | ⑫ Fuel hose                      | ㉒ Seat lock cable                     |
| ⑤ Carburetor heater hot water hose      | ⑬ Throttle position sensor lead  | ㉓ Ignitor unit                        |
| ⑥ Radiator reservoir tank breather hose | ⑭ Fuel pipe                      | ㉔ Rear turn signal light lead (right) |
| ⑦ Fuel pump                             | ⑮ Fuel sender coupler            | ㉕ Tail/brake light lead               |
| ⑧ Fuel filter                           | ⑯ Battery negative lead          | ㉖ Rear turn signal light lead (left)  |
|   | ⑰ Battery                        | ㉗ Tail/brake light bracket            |
|   | ⑱ Rear brake reservoir tank hose | ㉘ Starter motor lead                  |

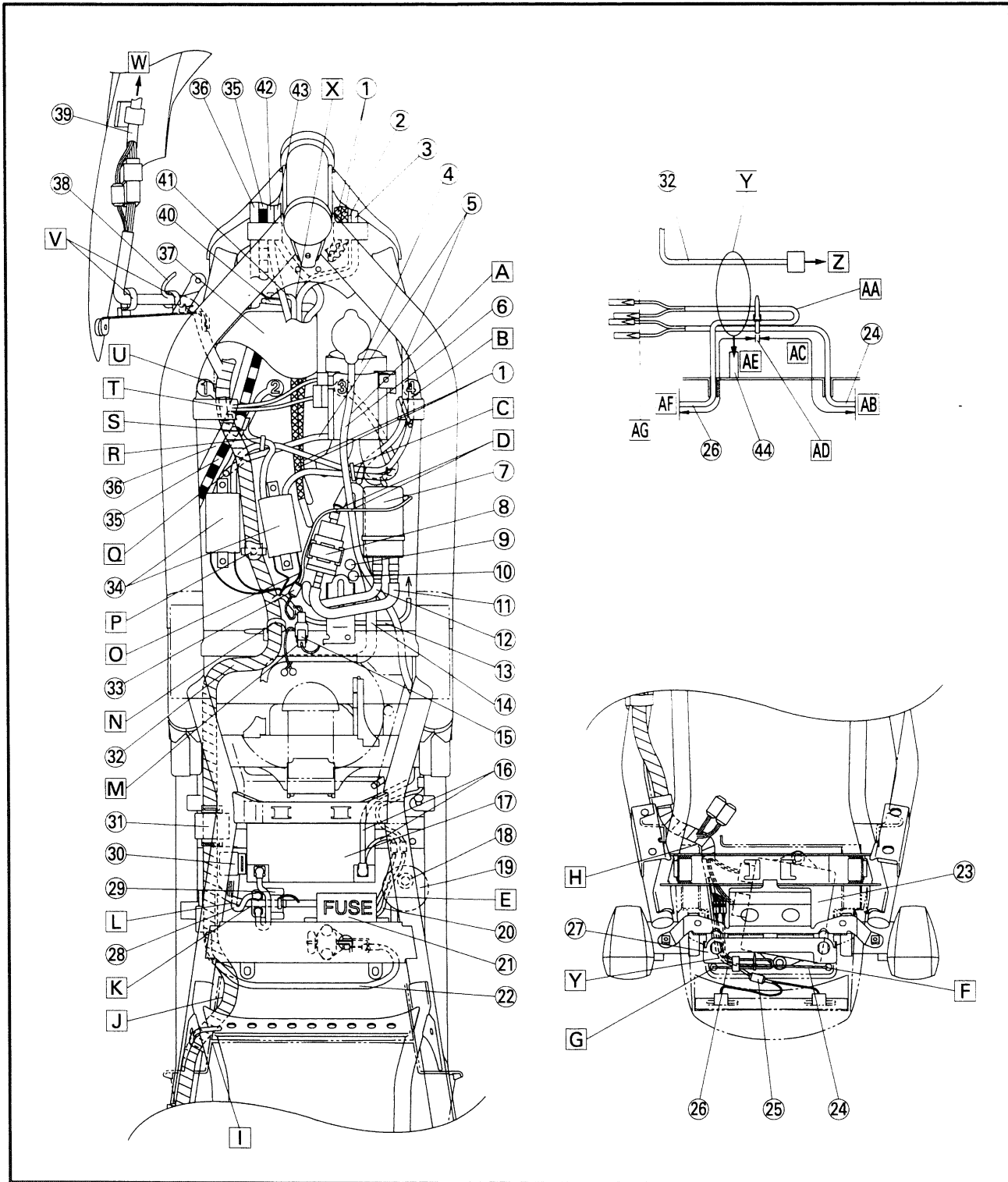



- |                                   |                               |
|-----------------------------------|-------------------------------|
| 29 Starter relay                  | 37 Box                        |
| 30 Turn signal relay              | 38 Horn lead                  |
| 31 Starting circuit cut-off relay | 39 Headlight sub-wire harness |
| 32 Wire harness                   | 40 Radiator fan motor lead    |
| 33 Fuel pump lead coupler         | 41 Rectifier/regulator lead   |
| 34 Ignition coil                  | 42 Left handlebar switch lead |
| 35 Clutch cable                   | 43 Main switch lead           |
| 36 Starter cable                  | 44 Clamp                      |

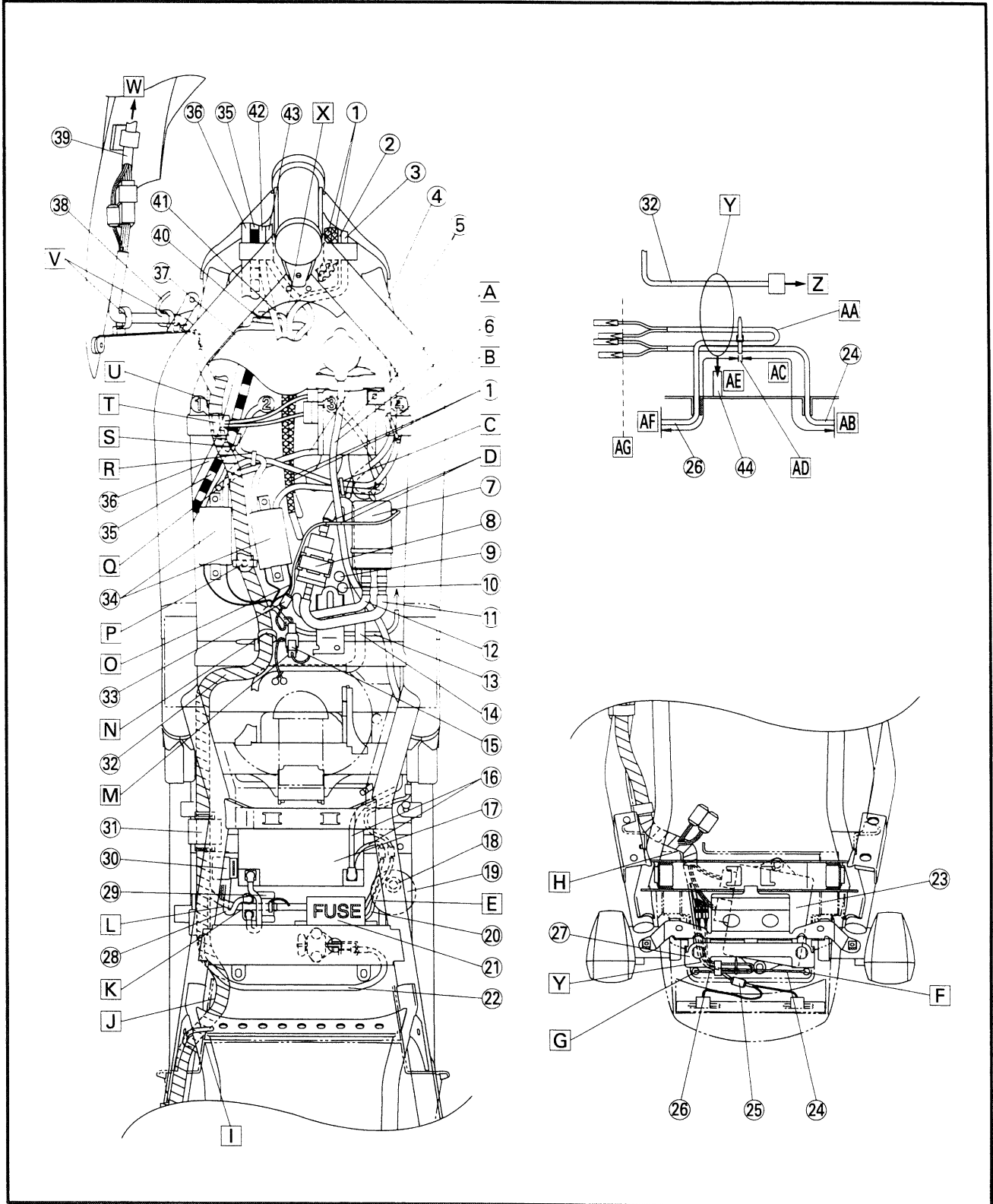



- A** Pass radiator reservoir tank breather hose at left side of thermostat housing.
- B** Do not fix #4 spark plug lead with a band.
- C** Using clamp, fix #3 and #4 spark plug lead and pass them under radiator reservoir tank breather hose, over the throttle cable, back of radiator hose and outside hot water hose for carburetor heater.
- D** Place fuel pump lead so that it comes on top.
- E** Pass brake light switch lead and battery negative lead under radiator reservoir tank, and between radiator reservoir hose and battery, and connect them at right side of battery.
- F** Pass rear turn signal light lead (right) through hole in rear fender.
- G** Pass rear turn signal light lead (left) through hole in rear fender.
- H** Pass the wire harness through cut in rear fender.
- I** Do not allow wire harness to ride over rear fender rib.

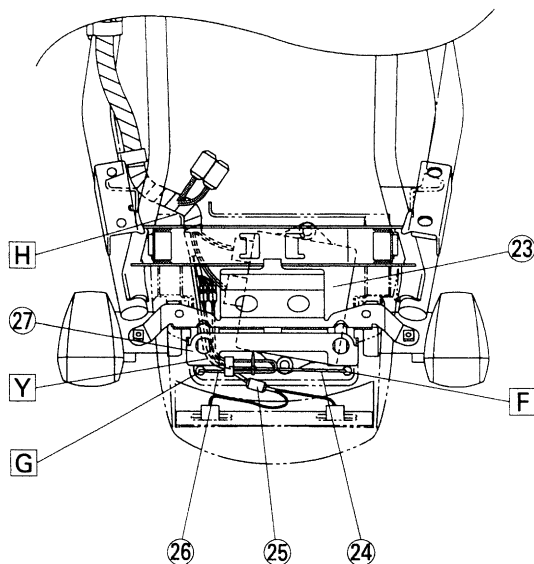
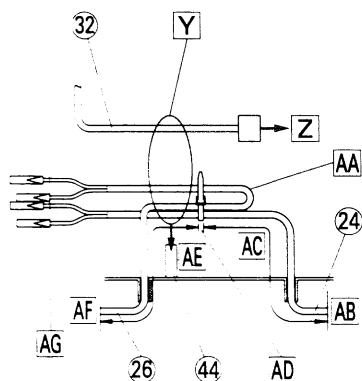
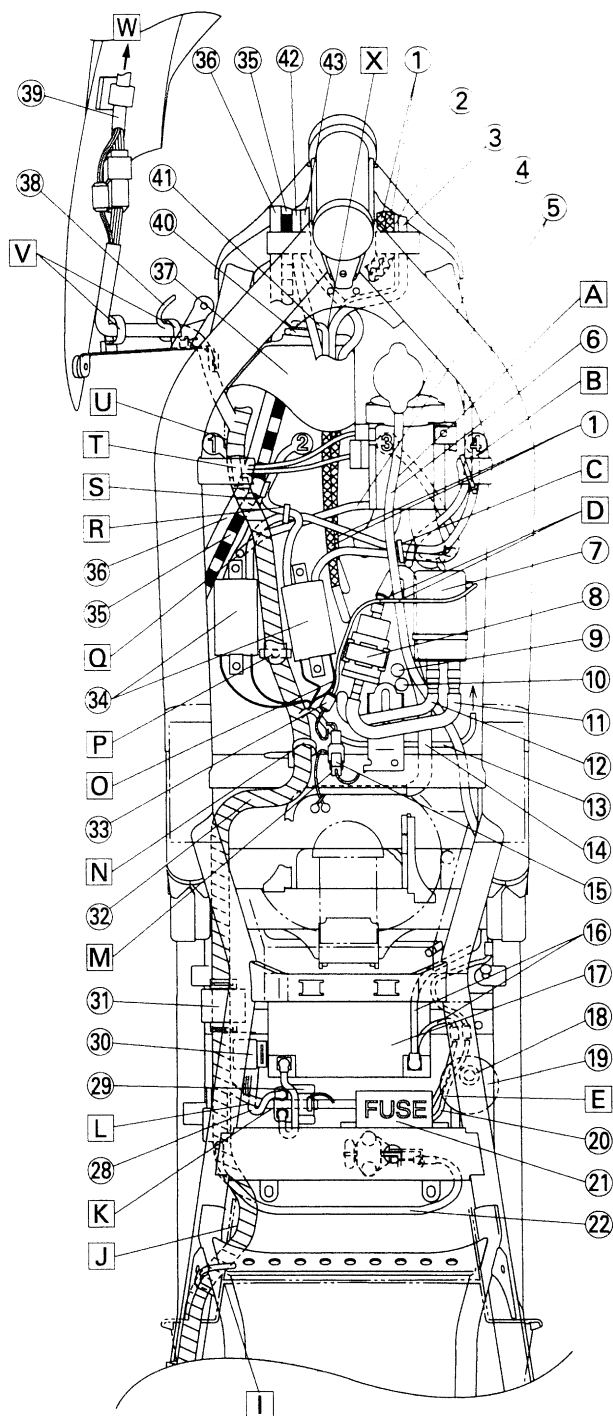



- J** Pass wire harness on the inside of vehicle from rear fender rib.
- K** Pass wire harness under starter relay.
- L** Pass starter motor lead under branched harness and put it upward.
- M** Fit fuel sender coupler onto cross pipe on frame.
- N** Using clamp, fix wire harness to cross pipe on frame. Locate clamp tip forward of vehicle.
- O** Pass fuel pump lead between ignition coil and filter, and push it downward.
- P** Using clamp, fix wire harness to the stay.
- Q** Pass under #2 and #4 spark plug leads for layout.
- R** Using clamp, fix clutch cable and starter cable.
- S** Using clamp, fix #2 and #4 spark plug leads.
- T** Fit clamp fastened to wire harness onto T-stud on frame.
- U** Pass wire harenss through cut in box rear and connect it inside box.
- V** Using clamp, fix wire harness to bracket (at 2 positions)

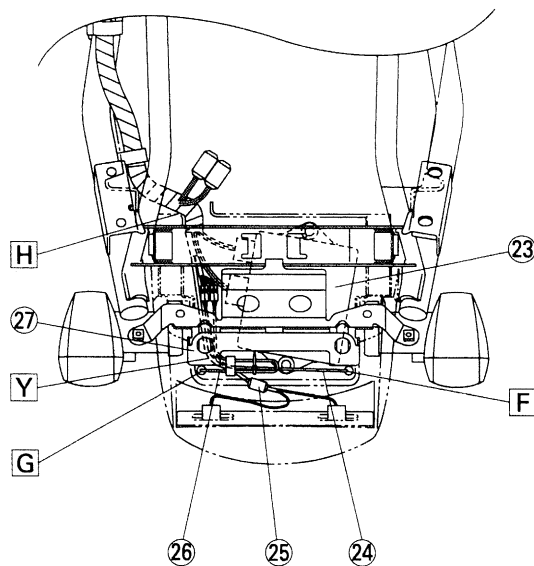
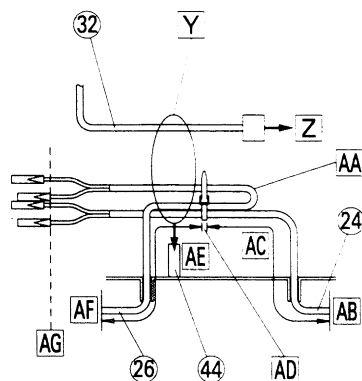
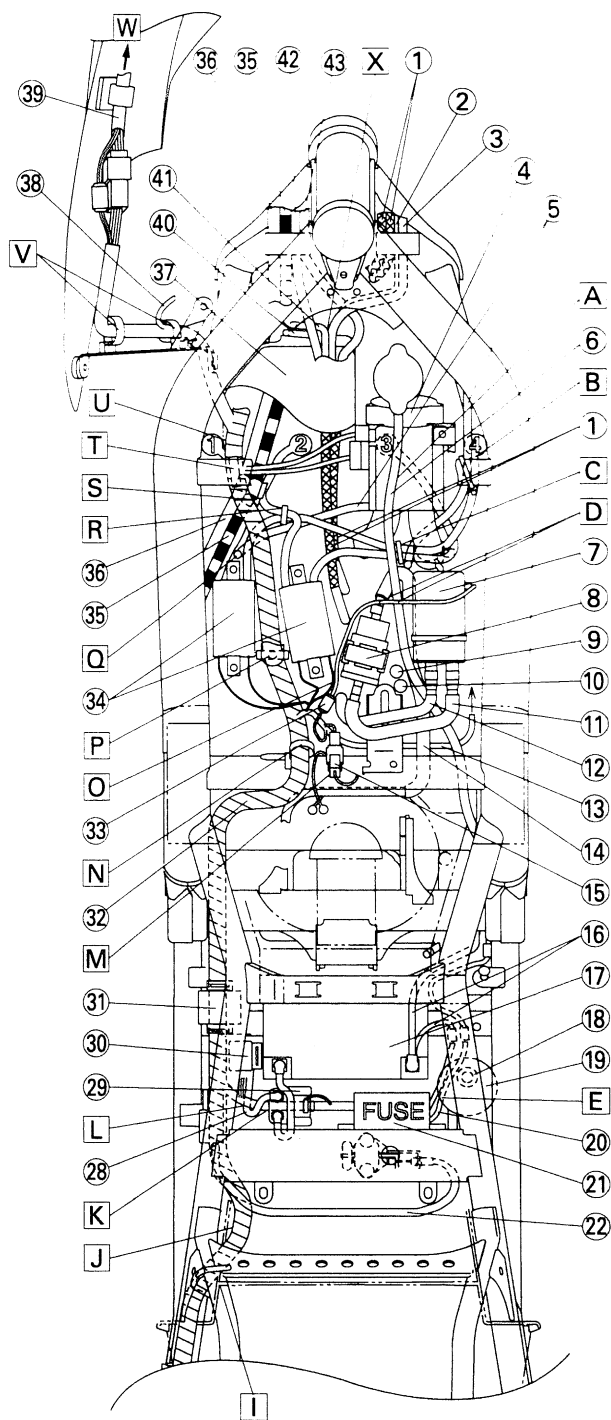



- W** To headlight lead

**X** Pass rectifier/regulator lead, radiator fan motor lead, left handlebar switch lead, main switch lead, right handlebar switch lead and speed sensor lead through cut in box front and connect them inside box.

**Y** Using clamp, fix wire harness after making sure to pass it under taillight bracket.
- Z** To taillight

**AA** Bend

**AB** Into turn signal light

**AC** No slack is permitted.

**AD** Clamp rear turn signal light leads (L and R) without slack.

**AE** Mate turn signal light reads (L and R) at coupler position, bend them and clamp them together with wire harness.
- AF** Into turn signal light

**AG** Mate at coupler position.

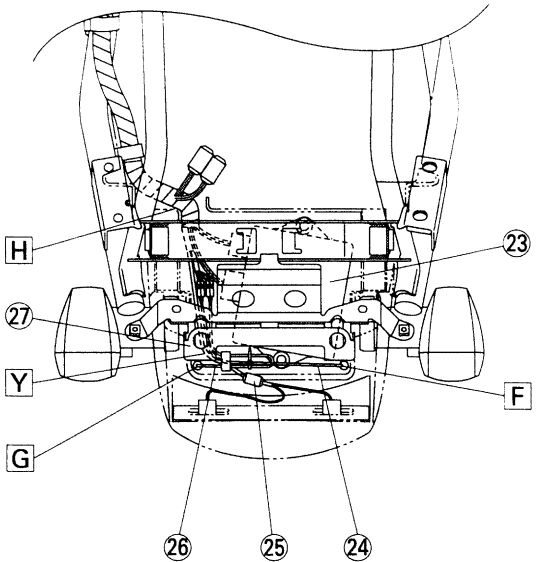
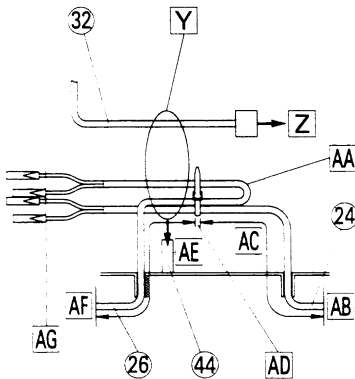
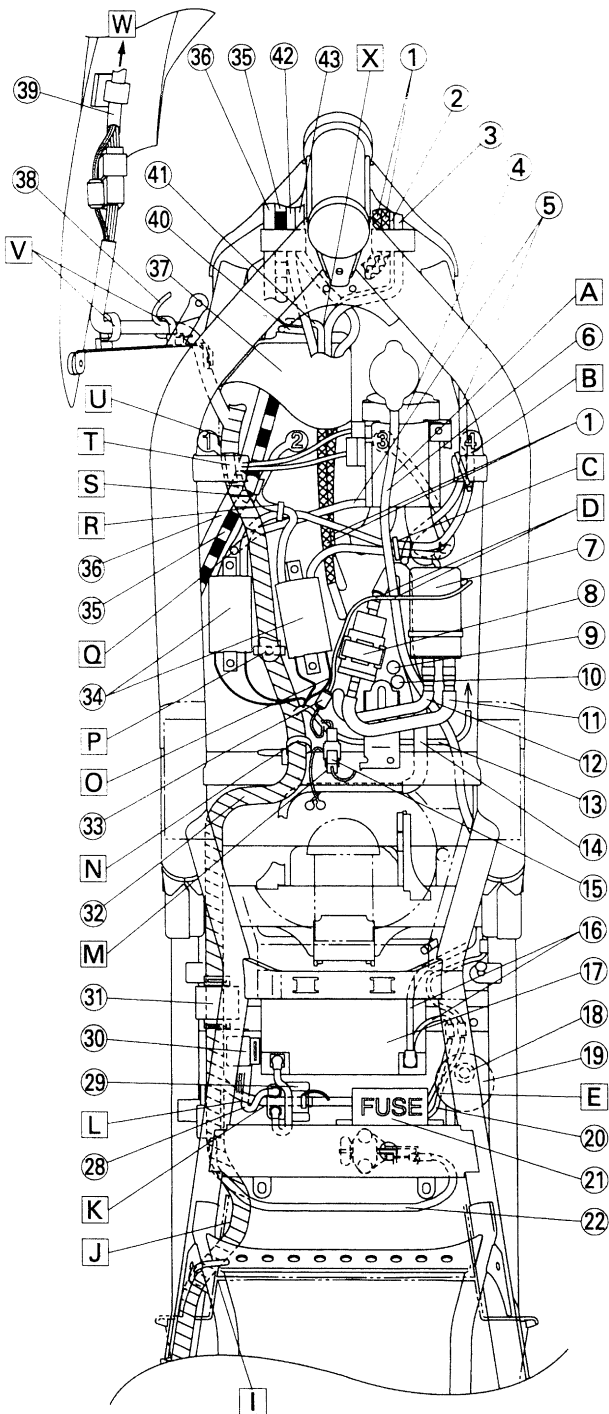



EAS00036

## PERIODIC CHECKS AND ADJUSTMENTS

### INTRODUCTION

This chapter includes all information necessary to perform recommended checks and adjustments. If followed, these preventive maintenance procedures will ensure more reliable vehicle operation, a longer service life and reduce the need for costly overhaul work. This information applies to vehicles already in service as well as to new vehicles that are being prepared for sale. All service technicians should be familiar with this entire chapter.

EAS00037

### PERIODIC MAINTENANCE/LUBRICATION INTERVALS

#### NOTE:

- The annual checks must be performed every year, except if a kilometer-based maintenance is performed instead.
- From 50,000 km, repeat the maintenance intervals starting from 10,000 km.
- Items marked with an asterisk should be performed by a Yamaha dealer as they require special tools, data and technical skills.

NO.		ITEM	CHECK OR MAINTENANCE JOB	ODOMETER READING ( × 1,000 km)					ANNUAL CHECK
				1	10	20	30	40	
1	*	Fuel line	• Check fuel hoses for cracks or damage.		√	√	√	√	√
2	*	Fuel filter	• Check condition.			√		√	
3		Spark plugs	• Check condition. • Clean and regap.		√		√		
			• Replace.			√		√	
4	*	Valves	• Check valve clearance. • Adjust	Every 40,000 km					
5		Air filter element	• Clean.		√		√		
			• Replace.			√		√	
6		Clutch	• Check operation. • Adjust	√	√	√	√	√	
7	*	Front brake	• Check operation, fluid level and vehicle for fluid leakage.	√	√	√	√	√	√
			• Replace brake pads.	Whenever worn to the limit					
8	*	Rear brake	• Check operation, fluid level and vehicle for fluid leakage.	√	√	√	√	√	√
			• Replace brake pads.	Whenever worn to the limit					
9	*	Brake hoses	• Check for cracks or damage.		√	√	√	√	√
			• Replace.	Every 4 years					
10	*	Wheels	• Check runout and for damage.		√	√	√	√	
11	*	Tires	• Check tread depth and for damage. • Replace if necessary. • Check air pressure. • Correct if necessary.		√	√	√	√	√
12	*	Wheel bearings	• Check bearing for looseness or damage.		√	√	√	√	
13	*	Swingarm	• Check operation and for excessive play.		√	√	√	√	
			• Lubricate with lithium-soap-based grease.	Every 50,000 km					
14		Drive chain	• Check chain slack. • Make sure that the rear wheel is properly aligned. • Clean and lubricate.	Every 1,000 km and after washing the motorcycle or riding in the rain					
15	*	Steering bearings	• Check bearing play and steering for roughness.	√	√	√	√	√	
			• Lubricate with lithium-soap-based grease.	Every 20,000 km					

# PERIODIC MAINTENANCE/LUBRICATION INTERVALS

**CHK**  
**ADJ**

NO.	ITEM	CHECK OR MAINTENANCE JOB	ODOMETER READING ( × 1,000 km)					ANNUAL CHECK
			1	10	20	30	40	
16	* Chassis fasteners	• Make sure that all nuts, bolts and screws are properly tightened.		✓	✓	✓	✓	✓
17	Sidestand, centerstand	• Check operation. • Lubricate.		✓	✓	✓	✓	✓
18	* Sidestand switch	• Check operation.	✓	✓	✓	✓	✓	✓
19	* Front fork	• Check operation and for oil leakage.		✓	✓	✓	✓	
20	* Shock absorber assembly	• Check operation and shock absorber for oil leakage.		✓	✓	✓	✓	
21	* Rear suspension relay arm and connecting arm pivoting points	• Check operation.		✓	✓	✓	✓	
		• Lubricate with lithium-soap-based grease.			✓		✓	
22	* Carburetors	• Check starter (choke) operation. • Adjust engine idling speed and synchronization.	✓	✓	✓	✓	✓	✓
23	Engine oil	• Change. • Check oil level and vehicle for oil leakage.	✓	✓	✓	✓	✓	✓
24	Engine oil filter cartridge	• Replace.	✓		✓		✓	
25	* Cooling system	• Check coolant level and vehicle for coolant leakage.		✓	✓	✓	✓	✓
		• Change.	Every 3 years					
26	* Front and rear brake switches	• Check operation.	✓	✓	✓	✓	✓	✓
27	Moving parts and cables	• Lubricate.		✓	✓	✓	✓	✓
28	* Lights, signals and switches	• Check operation. • Adjust headlight beam.	✓	✓	✓	✓	✓	✓

## NOTE:

- The air filter needs more frequent service if you are riding in unusually wet or dusty areas.
- Hydraulic brake service
  - Regularly check and, if necessary, correct the brake fluid level.
  - Every two years replace the internal components of the brake master cylinders and calipers, and change the brake fluid.
  - Replace the brake hoses every four years and if cracked or damaged.

FZS600 (P) 2002 WIRING DIAGRAM (EUR)

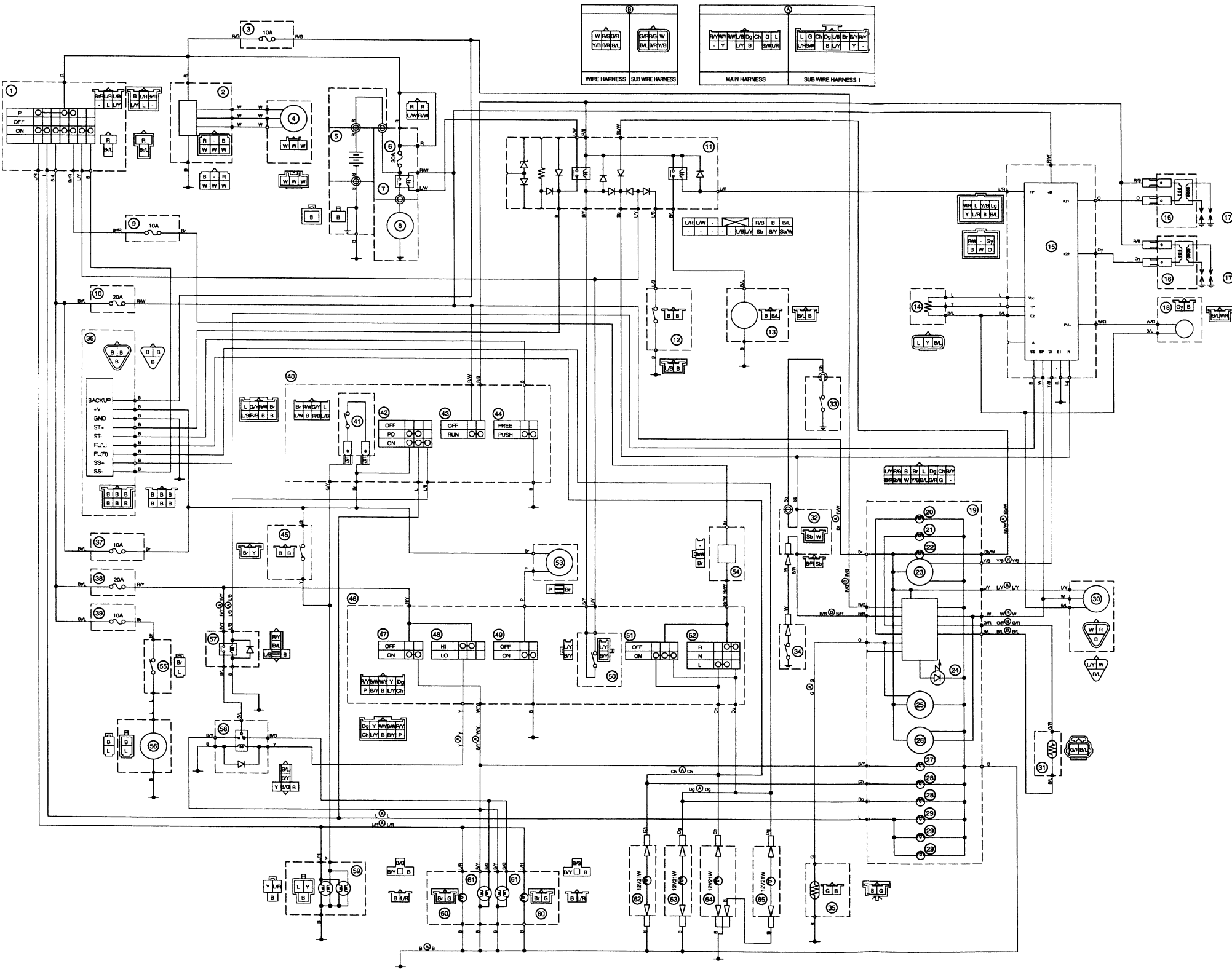

- ① Main switch
- ② Rectifier/Regulator
- ③ Backup fuse
- ④ Generator
- ⑤ Battery
- ⑥ Main fuse
- ⑦ Starter relay
- ⑧ Starter motor
- ⑨ Turn signal fuse
- ⑩ Ignition fuse
- ⑪ Starting circuit cut-off relay
- ⑫ Sidestand switch
- ⑬ Fuel pump
- ⑭ Throttle position sensor
- ⑮ Ignitor unit
- ⑯ Ignition coil
- ⑰ Spark plug
- ⑱ Pick up coil
- ⑲ Meter assembly
- ⑳ Fuel level warning light
- ㉑ Oil level warning light
- ㉒ Neutral indicator light
- ㉓ Tachometer
- ㉔ Coolant temperature warning light
- ㉕ Fuel meter
- ㉖ Speedometer
- ㉗ High beam indicator light
- ㉘ Turn signal indicator light
- ㉙ Meter light
- ㉚ Speed sensor
- ㉛ Thermo unit
- ㉜ Wire lead
- ㉝ Neutral switch
- ㉞ Oil level switch
- ㉟ Fuel sender
- ㊱ Alarm
- ㊲ Signaling system fuse
- ㊳ Headlight fuse
- ㊴ Radiator fan motor fuse
- ㊵ Right handlebar switch
- ㊶ Front brake light switch
- ㊷ Light switch
- ㊸ Engine stop switch
- ㊹ Start switch
- ㊺ Rear brake light switch
- ㊻ Left handlebar switch
- ㊼ Pass switch
- ㊽ Dimmer switch
- ㊾ Horn switch
- ㊿ Clutch switch
- 1 Hazard switch
- 2 Turn signal switch
- 3 Horn
- 4 Turn signal relay
- 5 Thermo switch
- 6 Radiator fan motor
- 7 Headlight relay (on/off)
- 8 Headlight relay (dimmer)
- 9 Tail/brake light
- 10 Auxiliary light
- 11 Headlight
- 12 Front turn signal light (left)
- 13 Front turn signal light (right)
- 14 Rear turn signal light (left)
- 15 Rear turn signal light (right)

COLOR CODE

- |          |              |           |                |
|----------|--------------|-----------|----------------|
| B .....  | Black        | Br/L .... | Brown/Blue     |
| Br ..... | Brown        | Br/W ...  | Brown/White    |
| Ch ..... | Chocolate    | G/R ....  | Green/Red      |
| Dg ..... | Dark green   | G/W ....  | Green/White    |
| G .....  | Green        | G/Y ....  | Green/Yellow   |
| Gy ..... | Gray         | L/B ....  | Blue/Black     |
| L .....  | Blue         | L/Y ....  | Blue/Yellow    |
| Lg ..... | Light green  | L/W ....  | Blue/White     |
| O .....  | Orange       | L/R ....  | Blue/Red       |
| Sb ..... | Sky blue     | Sb/W ...  | Sky blue/White |
| P .....  | Pink         | R/B ....  | Red/Black      |
| R .....  | Red          | R/G ....  | Red/Green      |
| Y .....  | Yellow       | R/Y ....  | Red/Yellow     |
| W .....  | White        | R/W ....  | Red/White      |
| B/G .... | Black/Green  | Y/B ....  | Yellow/Black   |
| B/L .... | Black/Blue   | W/R ....  | White/Red      |
| B/R .... | Black/Red    | W/Y ....  | White/Yellow   |
| B/Y .... | Black/Yellow |           |                |



# ***YAMAHA MOTORCYCLE PARTS & ACCESSORIES***

*Click on links below*

*[Yamaha Motorcycle Original Equipment Parts & Complete Online Diagrams](#)*

*[Yamaha Motorcycle Model History & Technical Specifications](#)*

*[Motorcycle Helmet Closeout Sale](#)*

*[Yamaha Motorcycle Parts & Accessories](#)*

*[Yamaha Dirt Bike Parts & Accessories](#)*

*[Save On All Motorcycle Tires](#)*

*[Motorcycle Gear Closeout Sale](#)*

*[High Visibility Motorcycle Gear](#)*

*[Cycle Gear – Free Shipping](#)*

*[Free Shipping On All Motorcycles](#)*

*[Discount Auto Parts – Free Shipping](#)*



*[www.ClassicCycles.org](http://www.ClassicCycles.org)*